

REV	DATE	REVISION DETAILS	APPD
更改号	日期	更改内容	审核并批准

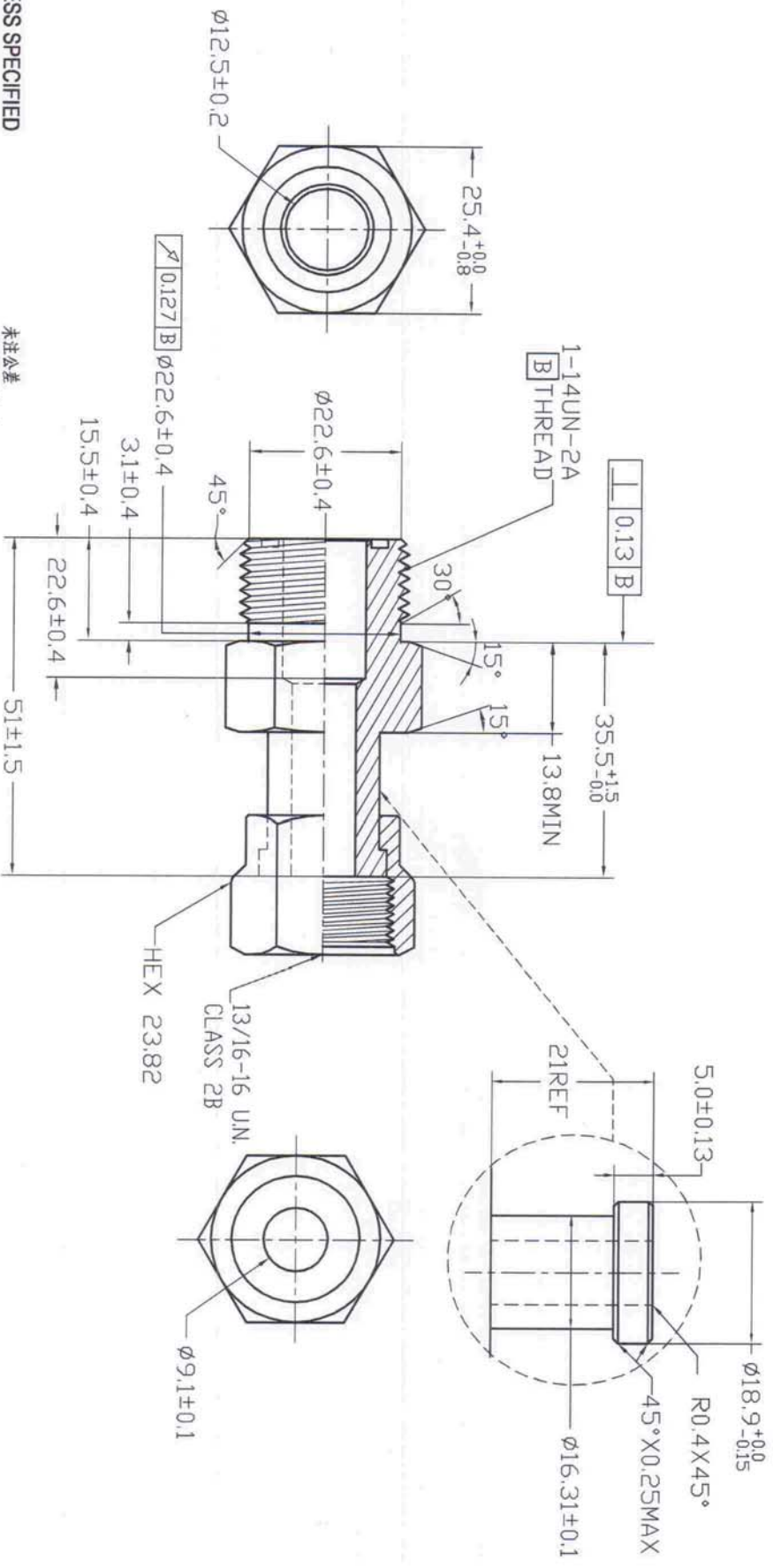

UNLESS SPECIFIED
 ALL DIMENSIONS IN mm
 MACHINED SURFACES Ra=3.2um
 ANGLE TOLERANCES ±1°
 DECIMAL TOLERANCES:
 .X: ±0.5
 .XX: ±0.25
 .XXX: ±0.127

未注公差
 图示尺寸单位为mm
 表面粗糙度Ra=3.2um
 角度公差±1°
 小数部分公差:
 .X: ±0.5
 .XX: ±0.25
 .XXX: ±0.127

MATERIAL Chinese steel 45

FINISH Remove all sharp edges, burrs, slivers and swarf, break all edges 0.127-0.254mm. 去除所有毛刺, 铁屑等残留物, 锐边倒钝0.127-0.254mm.
 ZINC PLATED WITH TRIVALENT CHROMATE AND NO RED CORROSION IN 96 HOURS SALT SPRAY TEST. 镀三价铬锌, 银白色, 96小时盐雾试验无红斑.

PART No 零件名		6900-10FS-8FS SW	
SCALE:		APPD:	DRN:
NTS		批准 Zhangjian	制图 Tangxiaolin
DATE: 18/09/13		日期	审核 LI Jianbiao
			2013.09.18

HANGZHOU HI-TECH INDUSTRY IMP. & EXP. CORP.

REV	DATE	REVISION DETAILS	APPD
更改号	日期	更改内容	审核员批准

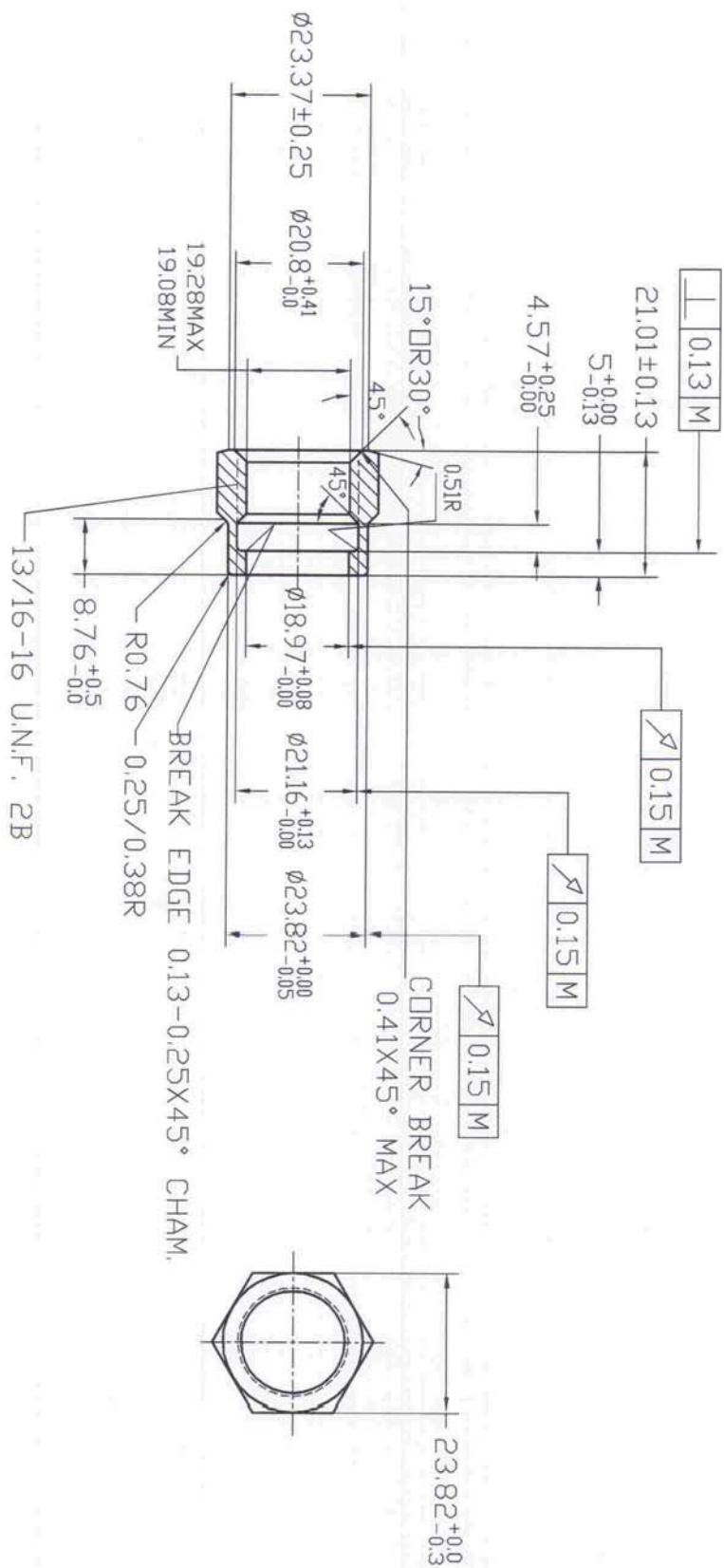

UNLESS SPECIFIED
 ALL DIMENSIONS IN mm
 MACHINED SURFACES Ra=3.2um
 ANGLE TOLERANCES ±1°
 DECIMAL TOLERANCES:
 .X: ±0.5
 .XX: ±0.25
 .XXX: ±0.127

未注公差
 图示尺寸单位为mm
 表面粗糙度Ra=3.2um
 角度公差±1°
 小数部分公差:
 .X: ±0.5
 .XX: ±0.25
 .XXX: ±0.127

MATERIAL	Chinese steel 45	SCALE: NTS		APPD: Zhangjian	DRN: Tangliulin
FINISH	Remove all sharp edges, burrs, slivers and swarf, break all edges 0.127-0.254mm, zinc plated with trivalent chromate and no red corrosion in 96 hours salt spray test.	PART No 6900-SWIVEL NUTS 8 #		DATE: 12/09/13	CHK: Lijunbiao
				2013.09.18	2013.09.18

HANGZHOU HI-TECH INDUSTRY IMP. & EXP. CORP.

13/16-16 U.N.F., 2B

BREAK EDGE 0.13-0.25X45° CHAM.
 R0.76 0.25/0.38R
 8.76±0.5

CORNER BREAK 0.41X45° MAX